

Extend Your Battery Life With Smart Battery Protector!!

Battery is the heart of your vehicle's electrical system. When you get into your caravan or pleasure boat, you just expect the battery will respond in good condition. Keep your battery life with the Smart Battery Protector to protect your expensive battery from over discharged. Simply connect it between the battery and the load; it will automatically monitor the battery voltage and disconnect the load when the voltage is low, thus keep your battery in safe condition and protect your battery from fully drained.



Suitable for any 12V or 24V batteries.
Available from 30A to 60A power.

**The battery is the heart of your 12 volts system.
It needs to be well taken care of !!**

The MOTORMATE Smart battery protectors are developed to meet the modern automobile applications. It protects the battery from fully drained and thus extend the battery lifetime.

The smart battery protectors are designed with overload and short-circuit protection. It will automatically disconnect the battery if it has detected the battery voltage falls below 10.5Volts of a 12V battery and re-start if the battery voltage is back to normal. The disconnect voltage is selectable at three voltage level.

MODELS	SBP-12030	SBP-12060	SBP-24030	SBP-24060
OUTPUT POWER				
Maximum Current	30A	60A	30A	60A
INPUT				
Battery Voltage	12VDC (10.5~16VDC)		24VDC (21~32VDC)	
OUTPUT				
Battery Low Cut-off : STD	11.0VDC ±0.2V		22.0VDC ±0.2V	
Battery Low Cut-off : LO	10.5VDC ±0.2V		21.0VDC ±0.2V	
Battery Low Cut-off : HI	11.5VDC ±0.2V		23.0VDC ±0.2V	
Battery re-connect	12.5VDC ±0.2V		25.0VDC ±0.2V	
PROTECTIONS				
Reverse protect			Yes	
Ignition protect			Yes	
Overload protect			Yes	
Short circuit protect			Yes	
PHYSICAL				
Input connection	Red/Black cables with ring terminal			
Output connection	Red/Black cables with cord-end terminal			
Ventilation	Natural			
Weight (Kg)	0.4	0.6	0.4	0.6
Size (cm) L x W x H	12x7x5	15x7x5	12x7x5	15x7x5

Specifications subject to change without notice.

POWERSAVER COMPUTER POWER LTD.

11/F., Tai Fung Ind. Bldg., 61 Hung To Road, Kwun Tong, Kowloon, Hong Kong.

TEL: (852) 2763-5070 FAX: (852) 2763-7538

http://www.powersaver.com.hk E-mail: info@powersaver.com.hk

ISO 9001
Manufactured



Combo Power Box

PowerSaver®
MOBILE AC POWER SOURCE

Plug-in and forget it!
Fully automatic control between AC Mains and Power Inverter.

The Combo Power Box is developed to give an "Instant Back-up" continue AC power to the loads. It provides a convenient connection between the Mains and the DC-AC power inverter and the battery charger.

It will automatically switch to inverter operation if it has detected blackouts thus provides a continue operation to the loads. When AC power back to normal, it will disconnect the power inverter and supply the AC to the loads directly.



MODELS	CP-822	CP-823
OUTPUT POWER		
Maximum	2000W	3000W
AC INPUT		
Voltage	120VAC / 2300VAC +/-20%	
Frequency	50/60 Hz +/-5%	
SWITCHING TIME		
From Mains to Inverter	0.5 sec	
From Inverter to Mains	0.2 sec	
INDICATIONS		
AC Input normal	Green,	
Inverter Input	Yellow	
AC Output normal	Green	
PROTECTIONS		
Over load protection	Yes	
Surge protection	Yes	
Short circuit protection	Yes	
PHYSICAL		
Ventilation	Natural	
Weight	1.3Kg	1.6Kg
Size (cm) L x W x H	22x15x75	22x15x75

*Output Receptacle Option



COMBO POWER BOX - RV / MARINE INSTALLATION WITH DC-AC INVERTER AND BATTERY CHARGER

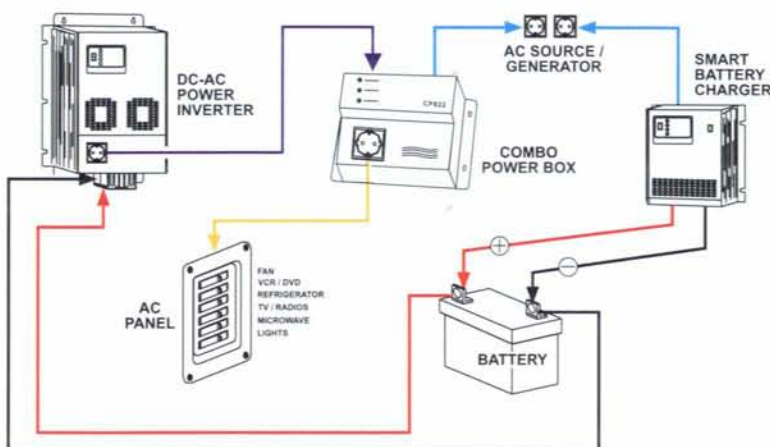

ISO 9001
Manufactured
UKAS
QUALITY
MANAGEMENT





MOTORMATE compact DC - DC isolated Power Converter utilizing latest switch-mode technology are developed to meet the modern automobile applications. Galvanic isolated means you can connect to any loading without worrying about the interruption or corrosion from input to the output. You can even use this converter to charging the battery to extend the battery life cycle. Series or Parallel operation gives you the great flexibility to expand the power whenever is required. This DC-DC fully isolated power converter is ideally to use in any application where a stable and clean DC voltage is needed.

Features:

- High efficiency
- Ignition protected
- Galvanic isolated
- Low ripple & noise
- Compact and lightweight
- User-friendly LED display
- EMC interference immunity
- Regulated output voltage
- Series or parallel operation
- Suitable for battery charging

Protections:

- Overload protected
- Short circuit protected
- Overheat protected
- Ignition protected

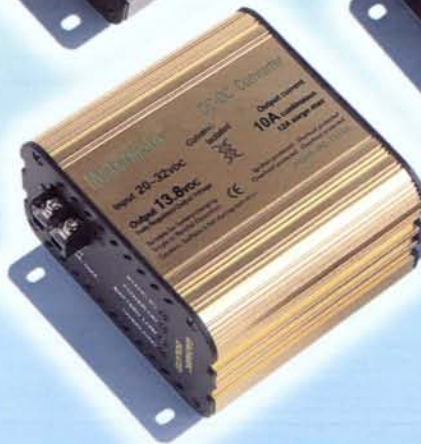

ISO 9001
Manufactured



Available on input voltage:

- 12VDC to 27.6VDC
- 24VDC to 13.8VDC
- 36VDC to 13.8VDC
- 48VDC to 13.8VDC

Converts a clean and stable DC voltage for vehicles, marine fitted with 24V or 12V electrical systems, e.g. Trucks, Boats, Tractors, Service Vehicles, Forklift truck etc.

Galvanic Isolated



Easy to install and provide a Low noise, fully regulated and isolated DC output.

The Motormate DC-DC Isolated Power Inverter is ideally to run electrical appliance in caravan Motor home, truck or boat where it is necessary to run 12VDC from the 24VDC battery system or vice versa. Galvanic isolated system means it can be connected to any loading without worrying about line loss and interruption from input to the output. Single or Parallel / Series operation gives you the great flexibility to expand the power whenever is needed.

Technical Specifications 12V / 24V models

MODELS	IPC-1205	IPC-1210	IPC-1215	IPC-1220	IPC-2110	IPC-2120	IPC-2130	IPC-2140
INPUT AND OUTPUT								
Continuous Output Current	5A	10A	15A	20A	10A	20A	30A	40A
Input Voltage	10 ~ 16VDC				20 ~ 32VDC			
Output Voltage	27.6VDC				13.8VDC			
Line Regulation	40mV				20mV			
Efficiency	90% at full load				90% at full load			
Ripple & Noise	50mV rms				30mV rms			
Load regulation	20mV from no load to full load				30mV from no load to full load			
PROTECTIONS								
Ignition Protected	Yes				Yes			
Short Circuit Protected	Yes				Yes			
Overload Protected	Yes				Yes			
Overheat Protected	Yes				Yes			
FEATURES								
Parallel operation	Yes, allow parallel connection				Yes, allow parallel connection			
Battery charging	Yes, suitable for battery boost charging				Yes, suitable for battery boost charging			
Galvanic isolated	Yes, input and output is fully isolated				Yes, input and output is fully isolated			
PHYSICAL								
Input connection	Cable with terminal rings				Cable with terminal rings			
Output connection	Terminal blocks				Terminal blocks			
Display	Green - Standby Mode, Green - Power On,				Yellow - Input Low, Red - Output Overload			
Cooling	Convention cooled		Thermally control cooling fan		Convention cooled		Thermally control cooling fan	
Operation temperature	-20°C to 50°C				-20°C to 50°C			
Case	Anodized aluminum case with mounting cover				Anodized aluminum case with mounting cover			
Weight (kg)	0.75	1.0	1.6	1.9	0.75	1.0	1.6	1.9
Size (cm) L x W x H	10 x 11.5 x 7	14 x 11.5 x 7	21 x 11.5 x 7	24 x 11.5 x 7	10 x 11.5 x 7	14 x 11.5 x 7	21 x 11.5 x 7	24 x 11.5 x 7

Specifications subject to change without prior notice.

Technical Specifications 36V / 48V models

MODELS	IPC-3110	IPC-3120	IPC-3130	IPC-3140	IPC-4110	IPC-4120	IPC-4130	IPC-4140
INPUT AND OUTPUT								
Continuous Output Current	10A	20A	30A	40A	10A	20A	30A	40A
Input Voltage	30 ~ 48VDC				40 ~ 60VDC			
Output Voltage	13.8VDC				13.8VDC			
Line Regulation	20mV				20mV			
Efficiency	90% at full load				90% at full load			
Ripple & Noise	30mV rms				30mV rms			
Load regulation	30mV from no load to full load				30mV from no load to full load			
PROTECTIONS								
Ignition Protected	Yes				Yes			
Short Circuit Protected	Yes				Yes			
Overload Protected	Yes				Yes			
Overheat Protected	Yes				Yes			
FEATURES								
Parallel operation	Yes, allow parallel connection				Yes, allow parallel connection			
Battery charging	Yes, suitable for battery boost charging				Yes, suitable for battery boost charging			
Galvanic isolated	Yes, input and output is fully isolated				Yes, input and output is fully isolated			
PHYSICAL								
Input connection	Cable with terminal rings				Cable with terminal rings			
Output connection	Terminal blocks				Terminal blocks			
Display	Green - Standby Mode, Green - Power On,				Yellow - Input Low, Red - Output Overload			
Cooling	Convention cooled		Thermally control cooling fan		Convention cooled		Thermally control cooling fan	
Operation temperature	-20°C to 50°C				-20°C to 50°C			
Case	Anodized aluminum case with mounting cover				Anodized aluminum case with mounting cover			
Weight (kg)	0.75	1.0	1.6	1.9	0.75	1.0	1.6	1.9
Size (cm) L x W x H	10 x 11.5 x 7	14 x 11.5 x 7	21 x 11.5 x 7	24 x 11.5 x 7	10 x 11.5 x 7	14 x 11.5 x 7	21 x 11.5 x 7	24 x 11.5 x 7

Specifications subject to change without prior notice.

POWERSAVER COMPUTER POWER LTD.

11/F., Tai Fung Ind. Bldg., 61 Hung To Road, Kwun Tong, Kowloon, Hong Kong.
 www.powersaver.com.hk e-mail: info@powersaver.com.hk
 Tel: (852) 2763-5070 Fax: (852) 2763-7538

DC-DC Isolated Power Booster

**Best for charging
battery from caravan
distance connection.**

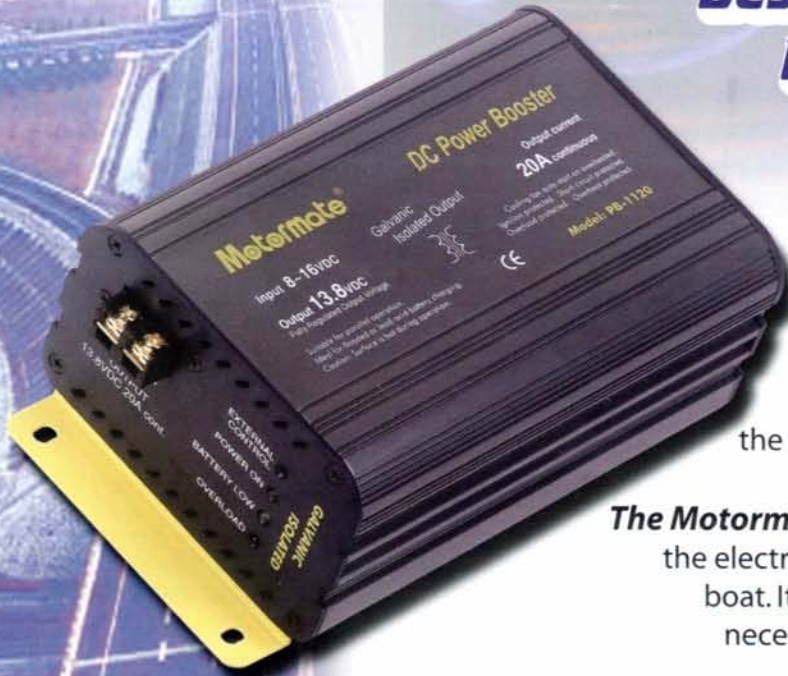

Modern mobile electronic and computer base device are required a stable and clean voltage supply in order to keep the device working at its best performance. Many of the chargers operated from the generator are unstable and will shorten the lifetime of the battery and electronic device.

The Motormate DC-DC isolated power booster is ideally to run the electrical appliance in motor home, trucks and pleasure boat. It can be installed in caravan or marine where it is necessary to charge battery from an unstable charging system and to compensate for line loss from long distance charging.

Soft Start System
Isolated Output



Galvanic isolated means you can connect to any loads without interruption from input to the output. External power on/off controls the booster from the vehicle engine to save energy while it is in idle.

Features:

- High efficiency
- Low ripple & noise
- Ignition protected
- EMC interference immunity
- Galvanic isolated
- External control operation
- Regulated output
- Ideal for battery charging



Available from :
Input : 12V / 24V
Output : 5A ~ 40A

DC-DC Isolated Power Booster

Motormate[®]
MOBILE DC POWER SOURCE

**Best for charging battery from
caravan distance connection.**

Soft Start System
Isolated Output



The MOTORMATE DC-DC isolated Power Booster designed with the latest switch-mode technology to meet the modern automobile applications. Install the Motormate Power Booster in motor home, caravan or marine to operate the electronic and computer base device at its best performance with a stable and clean voltage supply.

Charging the battery from a long distance connection without worrying about the line loss while in traveling. Single unit or parallel operation gives you the great flexibility to expand the power whenever is needed.

Technical Specifications 12V / 24V DC-DC Isolated Power Booster

MODELS	PB-1108	PB-1120	PB-1130	PB-1140	PB-2205	PB-2210	PB-2215	PB-2220
INPUT AND OUTPUT								
Continuous Output Current	8A	20A	30A	40A	5A	10A	15A	20A
Input Voltage	8 ~ 16VDC				20 ~ 32VDC			
Output Voltage	13.8VDC				27.6VDC			
Line Regulation	20mV				20mV			
Efficiency	85-90%				85-90%			
Ripple & Noise	30mV rms				50mV rms			
Load regulation	30mV from no load to full load				30mV from no load to full load			
PROTECTIONS								
Ignition Protected	Yes				Yes			
Short Circuit Protected	Yes				Yes			
Overload Protected	Yes				Yes			
Overheat Protected	Yes				Yes			
FEATURES								
Parallel operation	Yes, allow parallel connection				Yes, allow parallel connection			
Battery charging	Yes, suitable for battery boost charging				Yes, suitable for battery boost charging			
External control	Yes, power on after engine start up				Yes, power on after engine start up			
Galvanic isolated	Yes, input and output is fully isolated				Yes, input and output is fully isolated			
PHYSICAL								
Input connection	Cable with terminal rings				Cable with terminal rings			
Output connection	Terminal blocks				Terminal blocks			
Display	External control, Green - Power On, Yellow - Input Low, Red - Output Overload							
Cooling	Convention	Thermally control cooling fan			Convention	Thermally control cooling fan		
Operation temperature	-20°C to 50°C				-20°C to 50°C			
Case	Anodized aluminum case with mounting cover				Anodized aluminum case with mounting cover			
Weight (kg)	0.75	1.2	1.7	2.1	0.75	1.2	1.7	2.1
Size (cm) L x W x H	10 x 11.5 x 7	16 x 11.5 x 7	25 x 11.5 x 7	27 x 11.5 x 7	10 x 11.5 x 7	14 x 11.5 x 7	25 x 11.5 x 7	27 x 11.5 x 7

Specifications subject to change without prior notice.

POWERSAVER COMPUTER POWER LTD.

11/F., Tai Fung Ind. Bldg., 61 Hung To Road,
Kwun Tong, Kowloon, Hong Kong.
Tel: (852) 2763-5070 Fax: (852) 2763-7538
<http://www.powersaver.com.hk>
E-mail: info@powersaver.com.hk

Powersaver is a trademark of Powersaver Computer Power Ltd.
Copyright © Powersaver Computer Power Ltd. All rights reserved.